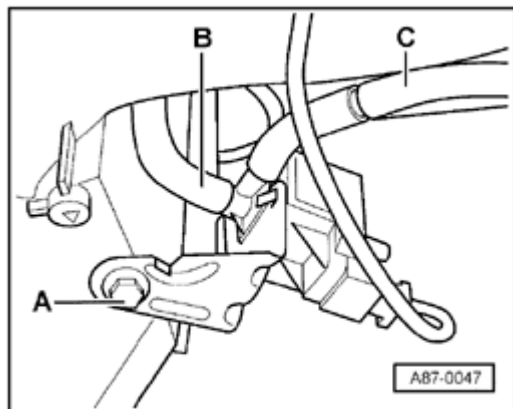

## Vacuum system, servicing

### Fresh/recirculating air flap vacuum unit, testing

**A**

- Detach hose -C- from two-way valve and connect vacuum pump US 8026, VAG1390 (or equivalent) to hose.
- Produce a vacuum (fresh/recirculating air flap moves against stop in recirculating air mode position and remains in this position).

**Note:**

Removing and installing vacuum unit ⇒ [page 87-186](#) .

## Fresh/recirculating air flap vacuum unit, removing and installing

- Remove heater/air conditioner assembly complete with instrument panel ⇒ [page 87-159](#) .
- ↳ - Remove screw A.
- Detach vacuum unit.
  - ◆ Setting X = 50 mm (1-31/32 in)
- Install in reverse order of removal.

### Notes:

- ◆ Do not disassemble air conditioner.
- ◆ When installing, check for free operation.
- ◆ Test vacuum system ⇒ [page 87-187](#) .

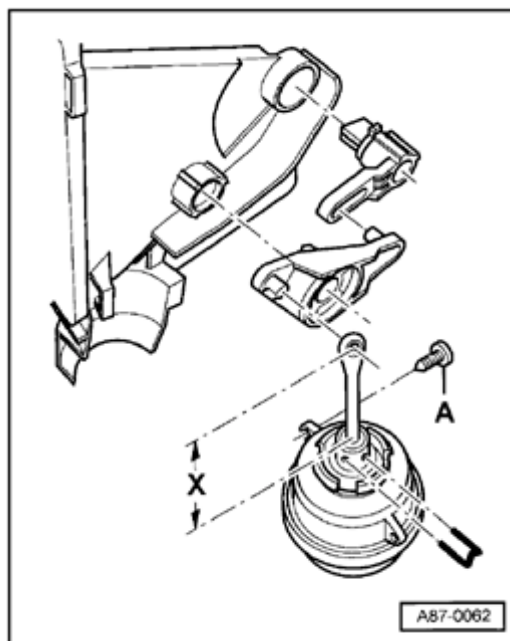

### Vacuum supply and one-way valve, testing

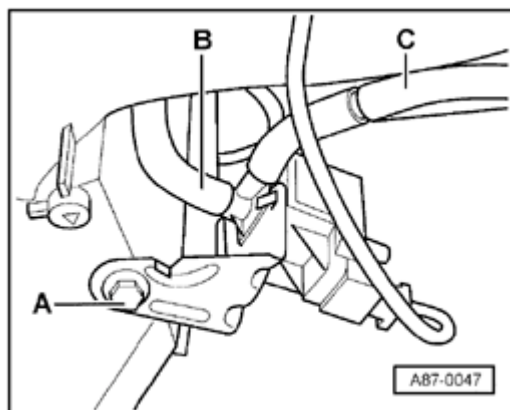

- A**
- Detach hose -B- from two-way valve (N63) and connect vacuum gauge VAG1368 (or equivalent) to hose.
  - Start engine and run at idle until the readout has stabilized.
  - Switch off engine. Vacuum reading on gauge must not drop by more than 50 mbar within 2 minutes.

#### Notes:

- ◆ *Specification for vacuum when engine running: greater than 250 mbar.*
- ◆ *Removing and installing vacuum reservoir and one-way valve ⇒ [page 87-188](#)*
- ◆ *Testing -N63-, output Diagnostic Test Mode (DTM) ⇒ [page 01-42](#) .*

### Vacuum reservoir with one-way valve, removing and installing

- Remove heater/air conditioner assembly complete with instrument panel ⇒ [page 87-159](#) .

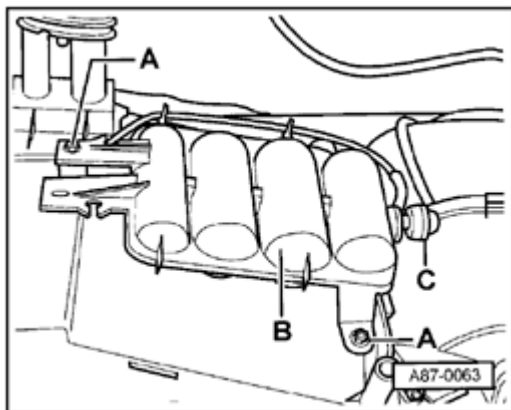

- Remove screws -A-.
- Install in reverse order of removal.

**Note:**

Testing vacuum system ⇒ [page 87-187](#) .